

High Power

# SEN Louvre CC 050 Fixture Guide

# KKDÖ

Indoor/Outdoor | Surface | Output up to 2255lm/m (687lm/ft)



## Key applications

- ✓ Backlighting/Signage
- ✓ Building façades
- ✓ Ceiling
- ✓ Downlighting
- ✓ Flood lighting
- ✓ Interior/Exterior
- ✓ Office lighting
- ✓ Public spaces
- ✓ Wall grazing

## Key features

- ✓ Custom lengths
- ✓ Diffusion: Spotting
- ✓ Direct view
- ✓ IP44
- ✓ IP67
- ✓ Lensed

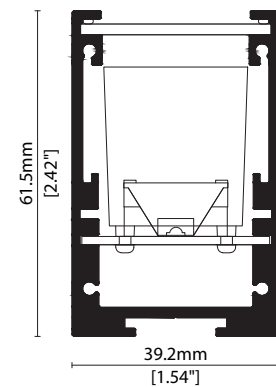

## MOUNTING METHODS



KKBK-02 Fixed bracket



KKBK-09 Mounting plate



KKBK-16 Small adjustable bracket



KKBK-17 Large adjustable bracket



KKBK-23 Low adjustable bracket



KKSU-05 Quick release suspension wire kit

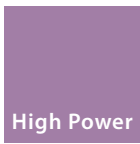

# SEN Louvre CC 050

## Specification sheet



<b>Dimensions</b>	H61.5/W39.2/L210-1810mm (H2.42/W1.54/L8.27-47.64in)
<b>PCB Cut-point</b>	100mm (3.94in)
<b>LED Pitch</b>	50mm - 20LED/m (1.97in - 6.1LED/ft)
<b>Chip</b>	<b>hcc-line:</b> CREE/Lumileds
<b>Cover/Optics</b>	Clear + 10°/20°/30°
<b>CCT</b>	<b>hcc-line White:</b> 2700K/3000K/3500K/4000K/5000K <b>hcc-line Single colours:</b> Red/Green/Blue
<b>LED binning</b>	<b>hcc-line:</b> 3-step MacAdam Ellipse
<b>CRI</b>	80 (2700K-4000K)/75 (5000K)
<b>Lifetime</b>	50,000 hours @ 25°C (50,000 hours @ 77°F)
<b>Operating temp</b>	350mA: T <sub>a</sub> = -25 to 75°C (T <sub>c</sub> max = 83.9°C) T <sub>a</sub> = -13 to 167°F (T <sub>c</sub> max = 183°F) 700mA: T <sub>a</sub> = -25 to 50°C (T <sub>c</sub> max = 65.7°C) T <sub>a</sub> = -13 to 122°F (T <sub>c</sub> max = 150.3°F)
<b>IP Rating</b>	IP44/67
<b>Finish</b>	Silver anodised
<b>Mounting</b>	Surface mounting via brackets
<b>Power feed</b>	Sheathed hardwire tail
<b>Control</b>	0-10V/1-10V/DMX/DALI via. External power supply options



### LED Grading Key

#### Exclusive Grade

<b>h-</b> <b>hcc-line*</b>	*KKDC tuned CCT range
Constant Current Lensed	
High Power LED	
3-step CCT range	

Power consumption	Supply voltage	Supply current
TYP. 20W/m (6.09W/ft) @ 350mA	TYP. 57V/m (17.37V/ft) @ 350mA	0.35/0.7A/m (0.11/0.21A/ft)
TYP. 41W/m (12.49W/ft) @ 700mA	TYP. 59V/m (17.98V/ft) @ 700mA	

	Clear Cover 10°	Clear Cover 20°	Clear Cover 30°	CRI	R9	Rf	Rg
<b>hcc-line</b>	1260lm/m (384lm/ft) 63lm/W @ 3000K, 350mA	1240lm/m (378lm/ft) 62lm/W @ 3000K, 350mA	1160lm/m (354lm/ft) 58lm/W @ 3000K, 350mA	-	-	-	-
	2255lm/m (687lm/ft) 55lm/W @ 3000K, 700mA	2255lm/m (687lm/ft) 55lm/W @ 3000K, 700mA	2091lm/m (637lm/ft) 51lm/W @ 3000K, 700mA	-	-	-	-

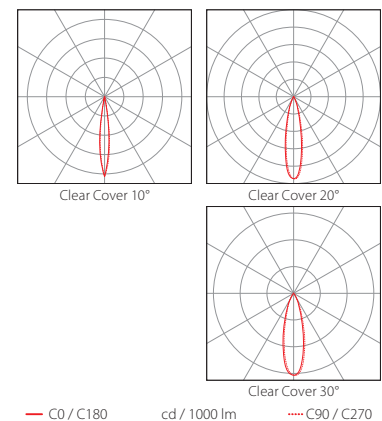
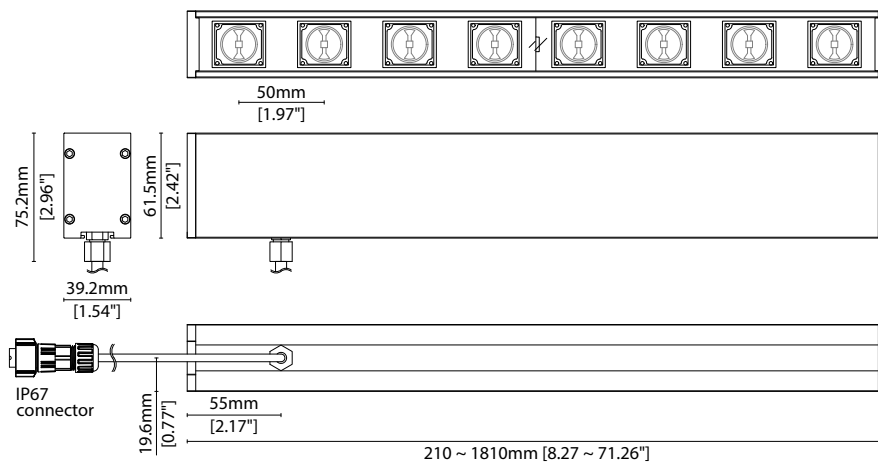

Data derived from independent UKAS/IESNA LM-79-08 accredited testing of production samples.



# SEN Louvre CC 050

## Code Table



### FIXTURE

Model	Finish	Cover/Lens <sup>1</sup>	Grade <sup>2</sup>	LED	Colour (CCT)	Length Availability <sup>3</sup>	IP	Cable Length	Power Feed <sup>4</sup>	Cable Exit <sup>5</sup>	Lens	Input		
SEN Louvre	SV Silver Anodised	Clear	B	h <sup>SC</sup> h	050	2700K 27	m 210-1810mm 100mm increments	IP44 44 IP67 <sup>6</sup> 67	1000mm 1000 /39.37"	Single ø6.3mm sheath tail	S00B	Rear Cable Exit RC	10° 10 20° 20 30° 30	Constant current (DC) a
					3000K 30									
					3500K 35	i 8.27-71.26in 3.94in increments  (Specify length code OR total run length)	IP67 <sup>6</sup> 67	1000mm 1000 /39.37"	Double ø6.3mm sheath tail	D00B	Side Cable Exit <sup>7</sup> SC	10° 10 20° 20 30° 30		
					4000K 40									
					5000K 50									
					RED RED									
					GREEN GRN									
					BLUE BLU									
Single ø6.3mm sheath IP67 connector	S67B	Side Cable Exit <sup>7</sup> SC	10° 10 20° 20 30° 30											
Double ø6.3mm sheath IP67 connector	D67B													

<sup>1</sup> Refer to **Cover/Lens Options** on **Options** pages

<sup>2</sup> Refer to **LED Grading Key** on **Specification sheet** page

<sup>3</sup> Refer to **Length Availability List** or enter total run length instead of length code

<sup>4</sup> Refer to **Power Feed Options** on **Options** pages

<sup>5</sup> Refer to **Cable Exit Options** on **Options** pages

<sup>7</sup> Due to the clear, flush potted polyurethane top layer on IP67 SEN a colour shift of +/-20K should be expected

<sup>7</sup> Low adjustable bracket needs side cable exit option

### Code Example:

SV	-	SA	-	B	-	h	-	050	-	30	-	m	1210	-	67	-	1000	-	S67B	-	RC	-	30	-	a
SEN Louvre		Silver Anodised		Clear		h <sup>SC</sup>		050		3000K		1210mm		IP67		1000mm/39.37"		Single ø6.3mm sheath IP67 connector		Rear Cable Exit		30°		Constant current (DC)	

### ACCESSORIES

#### Mounting Accessories

KKBK-02	Fixed bracket
KKBK-09	Mounting plate
KKBK-16	Small adjustable bracket
KKBK-17	Large adjustable bracket
KKBK-23	Low adjustable bracket
KKSW-05	Quick release suspension kit

\* Refer to **Mounting accessories** on **Accessories** pages

#### Exterior Junction Boxes

KKJB-07	IP67 Slim J-Box
KKJB-07R	Potting Resin for IP67 Slim J-Box

\* Refer to **Exterior Junction Boxes** on **Accessories** pages

#### PSU/Driver

0-10V/1-10V/DALI/DMX via External power supply options

\* Refer to **Driver/PSU Options** page for details or provide requirement and KKDC to offer the suitable option

### LED ENGINE VARIANTS (LED STRIP TYPE)

Colour	LED	Lumen/m	Lumen/ft	W/m	W/ft	Spec Doc	Length	Increment
Single CCT	033	3070	936	69.3	21.12	SEN Louvre CC 033	210-1210mm (8.27-47.64in)	100mm (3.94in)
	050	2107	642	46.2	14.08	SEN Louvre CC 050	210-1210mm (8.27-47.64in)	100mm (3.94in)
	100	1063	362	23.1	7.04	SEN Louvre CC 100	210-1210mm (8.27-47.64in)	100mm (3.94in)

\* Performance data: hcc-line, clear glass 10°, 700mA, 3000K

High Power

# SEN Louvre CC 050 (350mA) Length Availability List



Length Code		Fixture Length <sup>1</sup>		LED Strip <sup>2</sup>		End Cap Dimension <sup>3</sup>		Wattage (W)	Output (lm)
Metric	Imperial(US)	Metric	Imperial(US)	Metric	Imperial(US)	Metric	Imperial(US)		3000K (Test Data)
m0210	i0008	210mm	8.27in	200mm	7.87in	10mm	0.39in	3.94	247
m0310	i0012	310mm	12.20in	300mm	11.81in	10mm	0.39in	5.91	371
m0410	i0016	410mm	16.14in	400mm	15.75in	10mm	0.39in	7.88	494
m0510	i0020	510mm	20.08in	500mm	19.69in	10mm	0.39in	9.85	618
m0610	i0024	610mm	24.02in	600mm	23.62in	10mm	0.39in	11.82	741
m0710	i0028	710mm	27.95in	700mm	27.56in	10mm	0.39in	13.79	865
m0810	i0032	810mm	31.89in	800mm	31.50in	10mm	0.39in	15.76	988
m0910	i0036	910mm	35.83in	900mm	35.43in	10mm	0.39in	17.73	1112
m1010	i0040	1010mm	39.76in	1000mm	39.37in	10mm	0.39in	19.70	1235
m1110	i0044	1110mm	43.70in	1100mm	43.31in	10mm	0.39in	21.67	1359
m1210	i0048	1210mm	47.64in	1200mm	47.24in	10mm	0.39in	23.64	1482
m1310	i0048	1310mm	51.57in	1300mm	51.18in	10mm	0.39in	25.61	1606
m1410	i0048	1410mm	55.51in	1400mm	55.12in	10mm	0.39in	27.58	1729
m1510	i0048	1510mm	59.45in	1500mm	59.06in	10mm	0.39in	29.55	1853
m1610	i0048	1610mm	63.39in	1600mm	62.99in	10mm	0.39in	31.52	1976
m1710	i0048	1710mm	67.32in	1700mm	66.93in	10mm	0.39in	33.49	2100
m1810	i0048	1810mm	71.26in	1800mm	70.87in	10mm	0.39in	35.46	2223

<sup>1</sup> Actual total overall length of light fixture (LED strip + end caps + void/wire hole)

<sup>2</sup> Actual length of PCB strip

<sup>3</sup> Actual length of 2x end caps

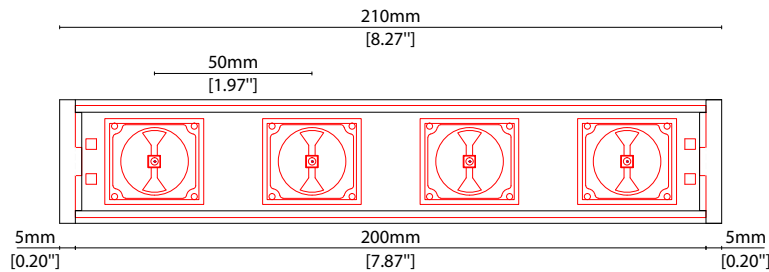

# SEN Louvre CC 050 (700mA) Length Availability List



Length Code		Fixture Length <sup>1</sup>		LED Strip <sup>2</sup>		End Cap Dimension <sup>3</sup>		Wattage (W)	Output (lm)
Metric	Imperial(US)	Metric	Imperial(US)	Metric	Imperial(US)	Metric	Imperial(US)		3000K (Test Data)
m0210	i0008	210mm	8.27in	200mm	7.87in	10mm	0.39in	8.10	447
m0310	i0012	310mm	12.20in	300mm	11.81in	10mm	0.39in	12.15	671
m0410	i0016	410mm	16.14in	400mm	15.75in	10mm	0.39in	16.20	894
m0510	i0020	510mm	20.08in	500mm	19.69in	10mm	0.39in	20.25	1118
m0610	i0024	610mm	24.02in	600mm	23.62in	10mm	0.39in	24.30	1341
m0710	i0028	710mm	27.95in	700mm	27.56in	10mm	0.39in	28.35	1565
m0810	i0032	810mm	31.89in	800mm	31.50in	10mm	0.39in	32.40	1788
m0910	i0036	910mm	35.83in	900mm	35.43in	10mm	0.39in	36.45	2012
m1010	i0040	1010mm	39.76in	1000mm	39.37in	10mm	0.39in	40.50	2236
m1110	i0044	1110mm	43.70in	1100mm	43.31in	10mm	0.39in	44.55	2459
m1210	i0048	1210mm	47.64in	1200mm	47.24in	10mm	0.39in	48.60	2683
m1310	i0048	1310mm	51.57in	1300mm	51.18in	10mm	0.39in	52.65	2906
m1410	i0048	1410mm	55.51in	1400mm	55.12in	10mm	0.39in	56.70	3130
m1510	i0048	1510mm	59.45in	1500mm	59.06in	10mm	0.39in	60.75	3353
m1610	i0048	1610mm	63.39in	1600mm	62.99in	10mm	0.39in	64.80	3577
m1710	i0048	1710mm	67.32in	1700mm	66.93in	10mm	0.39in	68.85	3801
m1810	i0048	1810mm	71.26in	1800mm	70.87in	10mm	0.39in	72.90	4024

<sup>1</sup> Actual total overall length of light fixture (LED strip + end caps + void/wire hole)

<sup>2</sup> Actual length of PCB strip

<sup>3</sup> Actual length of 2x end caps

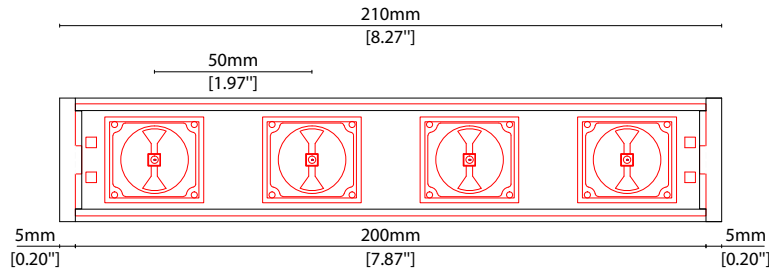



# SEN Louvre CC 050 Options



## COVER LENS OPTIONS

\* Options are an integral part of the fixture ordering codes. Please refer to **Code Table** pages.



**B 10** Clear cover 10° lens  
W39.2/H61.5mm (W1.54/H2.42")

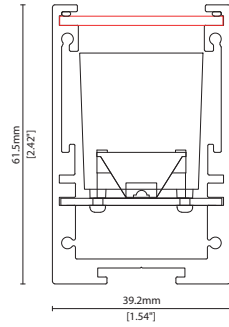

**B 20** Clear cover 20° lens  
W39.2/H61.5mm (W1.54/H2.42")

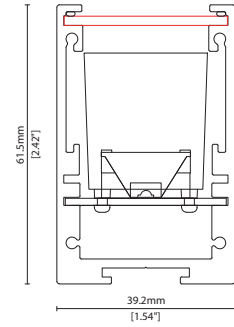

**B 30** Clear cover 30° lens  
W39.2/H61.5mm (W1.54/H2.42")

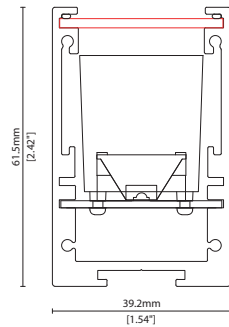

## CABLE EXIT OPTIONS



**RC** Rear cable exit

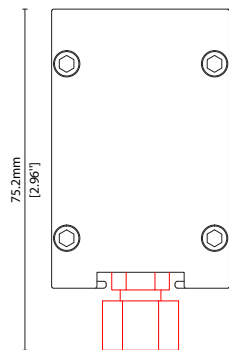

**SC** Side cable exit

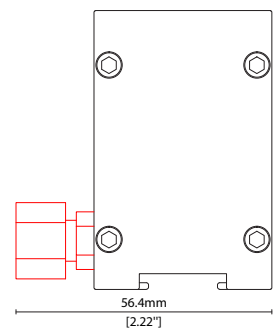



# SEN Louvre CC 050

## Options



### POWER FEED OPTIONS

1000 S00B 1000mm (39.37") Single  $\varnothing$ 6.3mm sheath tail

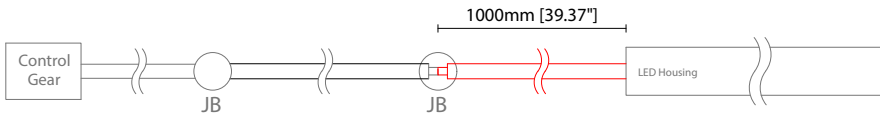

1000 D00B 1000mm (39.37") Double  $\varnothing$ 6.3mm sheath tail

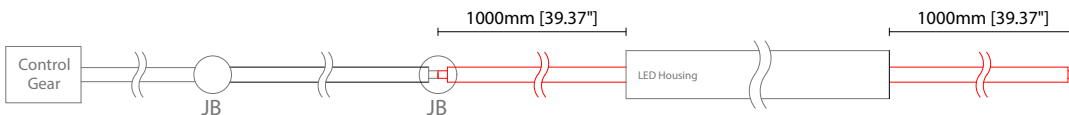

0300 S67B 300mm (11.81") Single  $\varnothing$ 6.3mm sheath IP67 connector

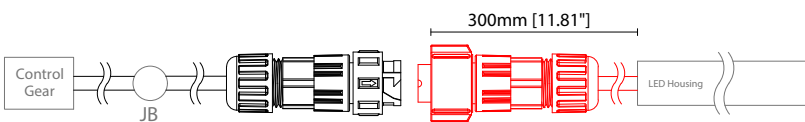

0300 D67B 300mm (11.81") Double  $\varnothing$ 6.3mm sheath IP67 connector

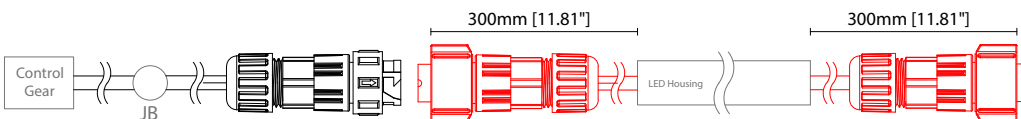

### IP67 2 Pin Connector

Female connector  
2 PIN (IP67)

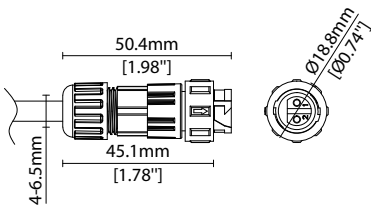

Male connector  
2 PIN (IP67)

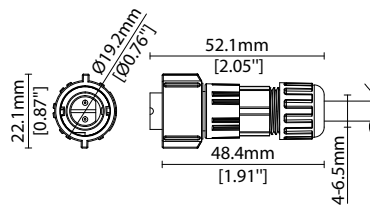

### Key

- Control Gear Power supply, sub-controllers & control systems
- JB Junction box / cable connection



High Power

# SEN Louvre CC 050 Accessories

# KKDÖ

## MOUNTING ACCESSORIES

Note: Accessories are to be ordered separately with corresponding code shown below.



**KKBK-02**

Fixed bracket (allow 2 per metre/40in)  
Steel finish  
Pre-assembled for double tail

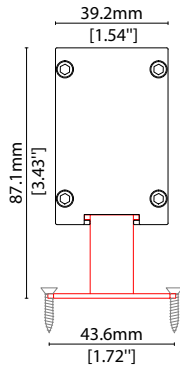

**KKBK-09**

Mounting plate  
(allow 2 per metre/40in – factory fitted)  
Silver anodised aluminium finish  
Pre-assembled for double tail

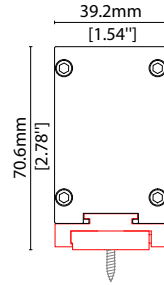

**KKBK-23**

Low adjustable bracket  
(allow 2 per metre/40in)  
Silver anodised aluminium finish  
Pre-assembled for double tail

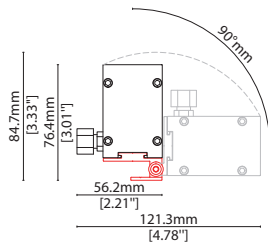

**KKBK-16**

Small adjustable bracket  
(allow 2 per metre/40in)  
Silver anodised aluminium finish  
Pre-assembled for double tail

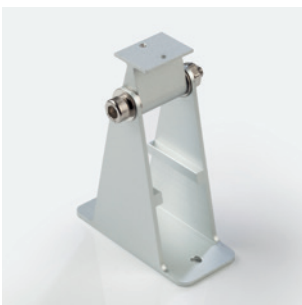
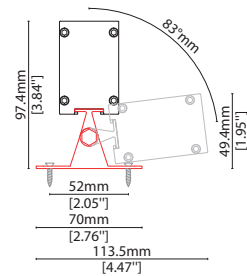

**KKBK-17**

Large adjustable bracket  
(allow 2 per metre/40in)  
Silver anodised aluminium finish  
Pre-assembled for double tail

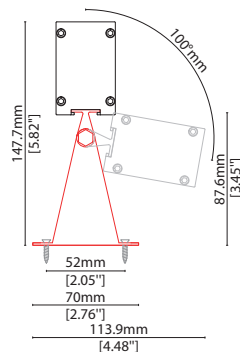

**KKSW-05**

Quick release suspension wire kit  
(1x pair of cables will support up to 2010mm length).

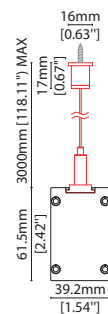





# SEN Louvre CC 050 Accessories



## EXTERIOR JUNCTION BOXES

---



KKJB-07

IP67 Slim J-Box  
(including type A,B,C,D bushings)



KKJB-07R

Potting resin for IP67 Slim J-Box



# SEN Louvre

## Driver/PSU Options



### AVAILABLE PSU OPTIONS

Control Mode	PSU (Order Code)	Input Voltage AC	Output Voltage DC	Rated Output Current	Rated Power	Dim %	IP Rating
Switched	HLG-60H-C350A	90-305V	100V-200V	0.35A	70W	-	IP65
	HLG-60H-C700A	90-305V	50V-100V	0.7A	70W	-	IP65
	HLG-80H-C350A	90-305V	128V-257V	0.35A	90W	-	IP65
	HLG-80H-C700A	90-305V	64V-129V	0.7A	90W	-	IP65
	HLG-120H-C350A	90-305V	215-430V	0.35A	150W	-	IP65
	HLG-120H-C700A	90-305V	107V-215V	0.7A	150W	-	IP65
	HLG-185H-C700A	90-305V	143V-286V	0.7A	199W	-	IP65
0-10V (1-10V)	HLG-60H-C350B	90-305V	100V-200V	0.35A	70W	-	IP67
	HLG-60H-C700B	90-305V	50V-100V	0.7A	70W	-	IP67
	HLG-80H-C350B	90-305V	128V-257V	0.35A	90W	-	IP67
	HLG-80H-C700B	90-305V	64V-129V	0.7A	90W	-	IP67
	HLG-120H-C350B	90-305V	215-430V	0.35A	150W	-	IP67
	HLG-120H-C700B	90-305V	107V-215V	0.7A	150W	-	IP67
	HLG-185H-C700B	90-305V	143V-286V	0.7A	199W	-	IP67
DMX	POWERdrive 1060/A	120 - 277V	2V-57V	0.35A, 0.7A	100W	-	-
	POWERdrive 106/M	120 - 277V	2V-57V	0.35A, 0.7A	100W	-	-
	POWERdrive 106/S	120 - 277V	2V-57V	0.35A, 0.7A	100W	-	-
	POWERdrive 1061/M	120 - 277V	2V-57V	0.35A, 0.7A	100W	-	-
	POWERdrive 1061/S	120 - 277V	2V-57V	0.35A, 0.7A	100W	-	-
DALI	ELG-100-C350DA	180-295V	143-286V	0.35A	100W	-	IP67
	ELG-100-C700DA	180-295V	71-143V	0.7A	100W	-	IP67
	ELG-150-C700DA	180-295V	150-300V	0.7A	150W	-	IP67